

## PILOT MEDIA SHUTTLE INSTALLATION INSTRUCTIONS

HELLO!

PILOT IS NOW USING A CUSTOM MEDIA FILE TRANSFER SYSTEM THAT IS MORE SECURE AND UTILIZES FASTER ACCELERATED FILE TRANSFERS THAN FTP OR HIGHTAIL.

PLEASE FOLLOW THE STEPS BELOW WHEN USING PILOT'S MEDIA SHUTTLE FOR THE FIRST TIME.

1)

ON YOUR FIRST ARRIVAL TO PILOT'S MEDIA SHUTTLE SITE, YOU WILL BE ASKED TO INSTALL A WEB BROWSER PLUGIN. YOU ONLY NEED TO DO THIS THE FIRST TIME. YOUR COMPUTER SHOULD NOT NEED ADMIN RIGHTS TO INSTALL. CLICK THE BLUE "INSTALL PLUGIN" BUTTON.

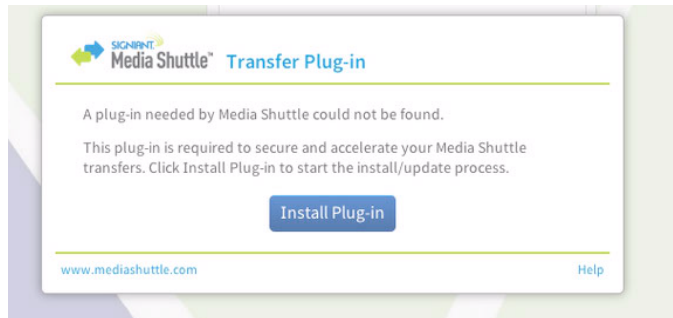

2)

INSTALLATION INSTRUCTIONS WILL APPEAR WHILE INSTALLER IS DOWNLOADING. FOLLOW THE INSTALL INSTRUCTIONS FOR MAC OR PC.

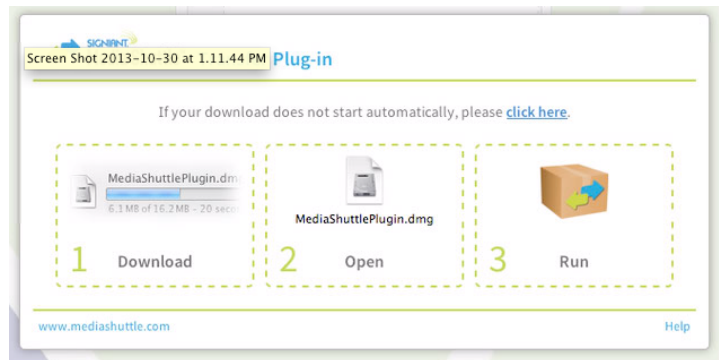

3)

AFTER OPENING THE .dmg FILE ON MAC, OR THE .exe FILE ON PC, DOUBLE CLICK THE INSTALLER ICON.



4) YOU WILL RECEIVE CONFIRMATION THAT THE PLUG-IN INSTALLATION IS COMPLETE. YOU ARE NOW SETUP TO DOWNLOAD AT ACCELERATED SPEEDS!



**\*\*\* NOTE: IF YOU ARE ON PC, AT THIS POINT CLICK THE ORIGINAL LINK YOU WERE SENT OR RELOAD THE PILOT SIGNIANT WEBPAGE**

5) SELECT THE FILES YOU WISH TO DOWNLOAD AND CLICK THE “DOWNLOAD” BUTTON. YOU WILL BE ASKED TO SELECT THE LOCATION ON YOUR SYSTEM WHERE YOU WOULD LIKE THE FILES STORED. CHOOSE THE LOCATION AND CLICK SAVE. DOWNLOAD WILL BEGIN.

SHOULD YOU ENCOUNTER ISSUES, PLEASE CONTACT:

Nathan Rausch  
Systems Administrator/ Post Production Supervisor  
nate@pilotnyc.com  
office: 212-500-6077